



CABLE 062 RF: RF CABLE ASSEMBLY, HIROSE H.FL + SMA BULK JACK + MULTIPLE CABLE SIZES - 3GHz

SPECIFICATIONS:

1. HIROSE H.FL PLUG, P/N: H.FL-LP
2. COAXIAL CABLE (SEE P/N OPTIONS)
3. SMA BULKHEAD JACK, P/N: RFCT-SMA010-F78.

NOTES:

1. THE ORIENTATION OF CONNECTORS ON DRAWING IS FOR REFERENCE ONLY, IF THE ORDER IS LEFT BLANK THE CONNECTOR WILL NOT HAVE FIXED ORIENTATION.
2. FIXED ORIENTATION IS SUGGESTED FOR CABLE LENGTH 25MM TO 100MM. PLEASE SPECIFY THE FIXED ORIENTATIONS FROM THE ORDER CODE (F1, F2, ETC)
3. CONTACT GRAD CONN IF THE ORIENTATION YOU REQUIRE IS NOT SHOWN.
4. WORKING FREQUENCY RANGE: DC-3GHz. Δ
5. OPERATING TEMPERATURE: -40°C TO +85°C.
6. IMPEDANCE: 50 OHM.

USAGE PRECAUTIONS: CABLES USING 'MICRO' COAX ARE DELICATE:

- (i) HANDLE WITH CARE.
- (ii) DO NOT TWIST; APPLY EXCESSIVE FORCES OR SHARP BENDS TO THE CABLE. DO NOT FORCEFULLY DEFORM WIRES.
- (iii) CONSULT CONNECTOR MANUFACTURER'S DATASHEETS FOR DETAILED NOTES ON HANDLING INSTRUCTIONS.

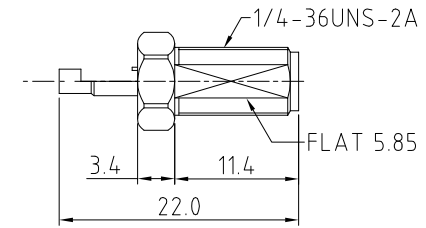
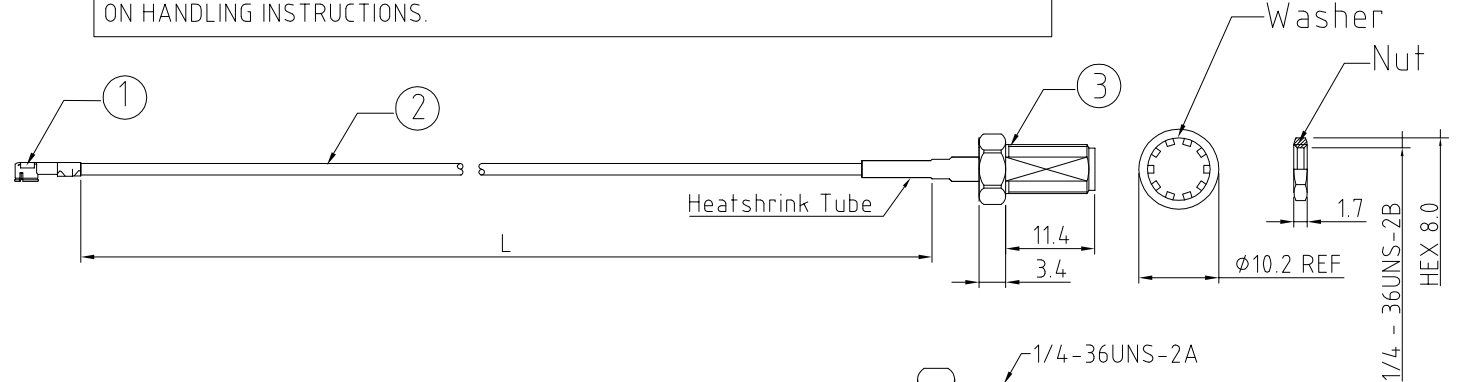

SMA JACK DETAIL DIMENSION

HOW TO ORDER
CABLE 062 RF - X X X - X - X X - X

"L" LENGTH IN MM
eg: 100MM = 0100
(MIN. 025-MAX.400)
STANDARD = 100, 150, 200)
Tolerance: <50mm : ±2mm.
51-200mm: ±5mm.
201-400mm: ±7mm.

CABLE SIZE OPTIONS:
BLANK = ϕ 1.48MM CABLE, COLOR: BLACK
 Δ 1 = ϕ 1.32MM CABLE, COLOR: BLACK
 Δ 2 = ϕ 1.32MM D.S. CABLE, COLOR: GRAY

ORIENTATION OPTIONS: Δ
BLANK = DOES NOT HAVE A FIXED ORIENTATION
F1 = H.FL CONNECTION DOWN (L=25-220MM)
F2 = H.FL CONNECTION UP (L=25-220MM)
(SEE NOTES 1, 2, 3 AND DIAGRAMS FOR MORE INFORMATION)

WASHER AND NUT OPTIONS:
BLANK = SEPERATELY PACKED (STANDARD)
A = ASSEMBLED WITH CONNECTOR

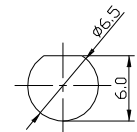
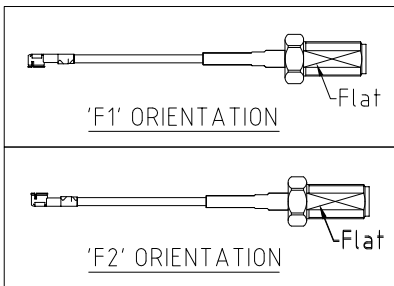

RECOMMENDED SMA MOUNTING HOLE

REV.	DATE & DRN
10	21/01/09 - CHG RELEASE
11	26/08/09-PCY
12	06/08/09-PCY
13	21/02/16 - NYW
14	06/08/17 - NYW
15	23/03/20 - NYW
16	16/10/23 - NYW

ADD WORKING FREQUENCY RANGE
ADD SMA DETAIL VIEWS
ADD #1.32MM CABLE TO OPTION 1
ADD ORIENTATION OPTIONS
ADD CABLE TO OPTION 2
AMEND SMA P/N FOR 1.48 CABLE
UPDATE SMA P/N
ADD NOTES 3 & 6

Scale: NTS	THIRD ANGLE	Unstated X .XX .XXX ANGLES	Tolerances: N/A N/A N/A N/A	Material SEE NOTE
Drawn: CHC				
App'd: XXX	Title: CABLE ASSEMBLY	NOT TO SCALE		
Date: 16 OCT. '23	Revision: 1.6	Unit: mm		

THIS DRAWING IS CONFIDENTIAL AND MUST NOT BE COPIED OR DISCLOSED WITHOUT WRITTEN CONSENT

Type: Cable 062 RF
CABLE 062 RF
Drawing Number:
Sheet 1 of 1
Drawing © E and O E